

PAGE-153

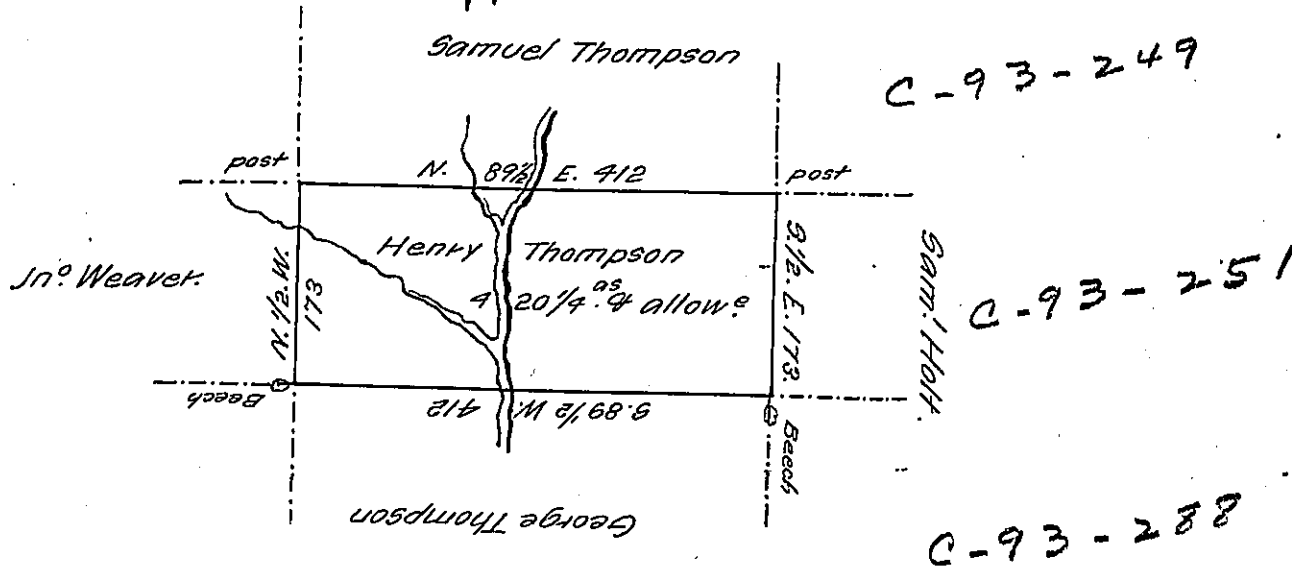

A Draught of a tract of land called _____ Situate in the
 County of Luzerne Adjoining Geo. Thompson & others surveyed the 25th
 day of Septem^r 1792 for Henry Thompson in pursuance of a Warrant
 beaking date the 3^d day of April 1792 Containing Four hundred twenty
 Acres & a quarter & the allow^e of Six P. Cent &c.

Ant. Crothers D.S.

To Dan. Brodhead Esq^r
 Surveyor General.

IN TESTIMONY that the above is a copy of the original remaining on file in
 the Department of Internal Affairs of Pennsylvania, made
 conformably to an Act of Assembly approved the 16th day of
 February, 1833, I have hereunto set my Hand and caused
 the Seal of said Department to be affixed at Harrisburg,
 this fifth day of February 1907.

Isaac B. Brown
 Secretary of Internal Affairs.